

CODE: **AWO534** v.1.0/II
NAME: **NVR enclosure/Monitor/RACK 10", 19"/vertical black**

EN

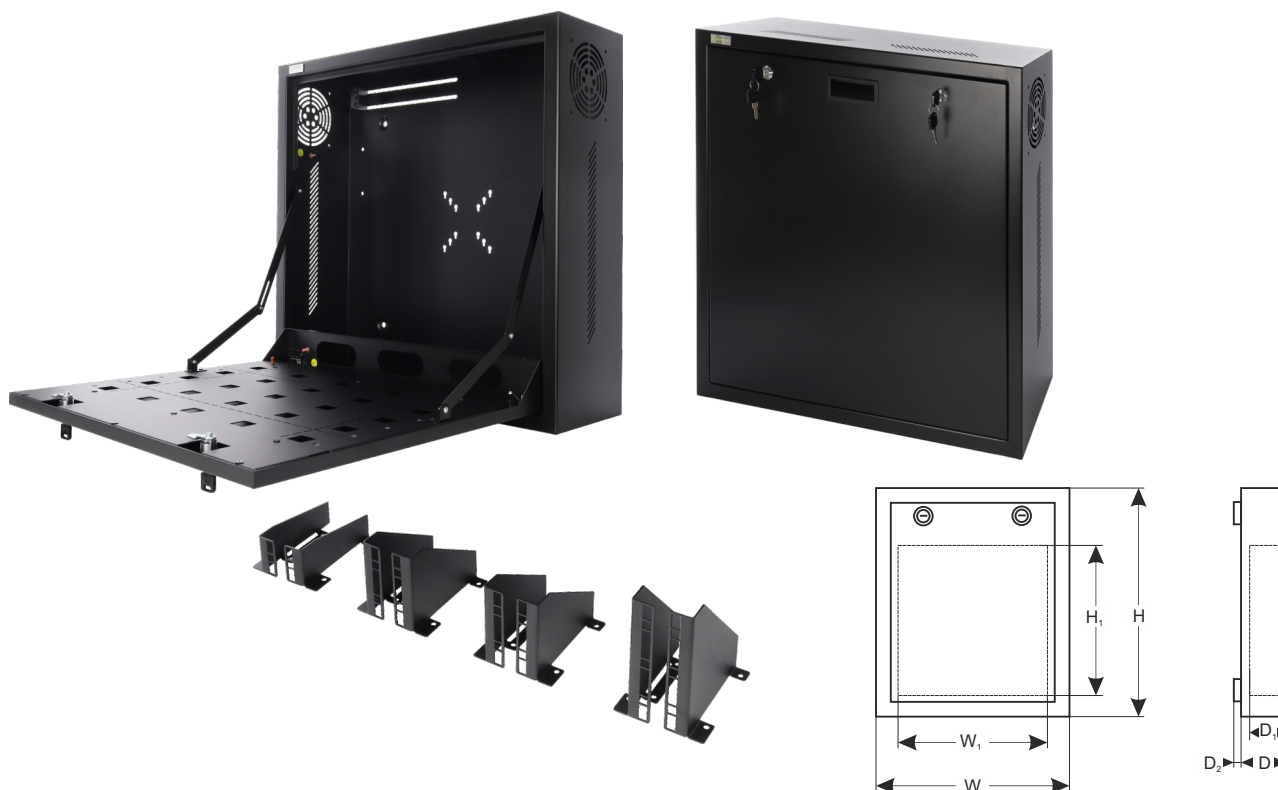

DESTINATION

Due to vertical installation and low depth, they are ideal for places where deeper enclosures or cabinets RACK 19" type cannot be installed.

AWO534 enclosure is dedicated to CCTV systems. Its universal design makes it suitable for simple CCTV installations as well as more complex and demanding ones. Due to vertical installation and low depth, they are ideal for places where deeper enclosures or cabinets RACK 19" type cannot be installed.

The enclosure can accommodate devices such as:

- monitor – monitor mounting standard: VESA 50x50 / VESA 75x75 / VESA 100x100
- switch – standard 19" rack / with special mounting brackets
- DVR – 19" rack standard / using tightening straps (ZPR - additional equipment)
- enclosed power supplies with battery backup: 52VDC-PWB / 54VDC-PSB + DCDC 12VDC converters
- patch panel – 19" rack standard
- power strip – standard 10"/ 19"
- fan RAW1

Enclosure is equipped with:

- adjustable 10" / 19" rack mount - 1U
- RACK brackets: 1U – 1 pc, 2U – 2 pcs, 3U – 1 pc,
- mounting plate in door - holes for switches and straps

19" rack holders – 1U / 2U / 3U can be installed on door of enclosure as well as in the bottom of enclosure. Total height of the installed RACK devices is 3U.

TECHNICAL DATA

External dimensions of enclosure	W=600, H=600, D+D ₂ =200+2,5 [±2 mm]
Dimensions of recorder space	W ₁ =490, H ₁ =385, D ₁ =175 [±2 mm]
Material	DC01 steel plate, thickness: 1.2 mm / 1.5mm Anticorrosion protection Colour: RAL 9004 (black)
Closing	Lock x 2 pcs (same code)
Destination	Indoor
Net/gross weight	21 / 22,8 [kg]
Notes	distance from the mounting surface – 2,5mm set includes two keys (same code), set includes two keys for each lock possibility to install RAW1 fan (optional)
Declarations, warranty	CE, 2 years

Components of enclosure:

RACK 19" brackets

- 1U – 1 set
- 2U – 2 sets
- 3U – 1 set

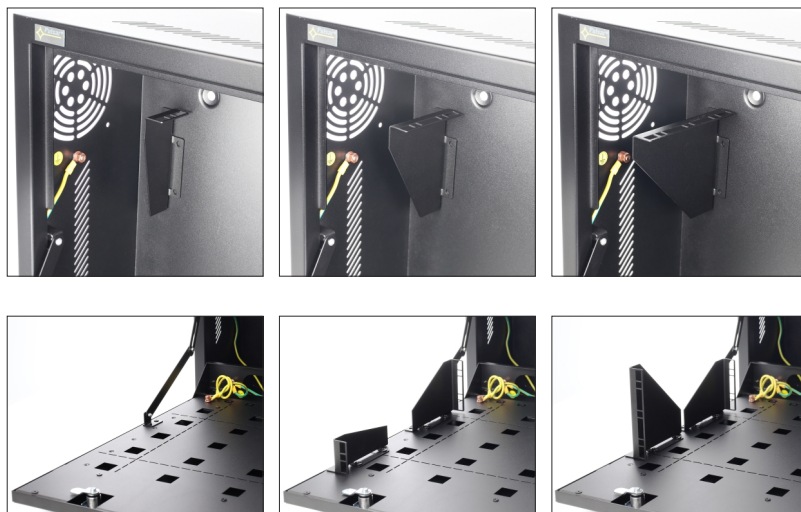
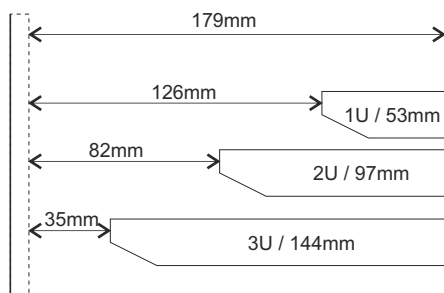

Distances inside enclosure after mounting 19" rack profiles, 179mm distance: hinged front door - bottom of the enclosure

Examples of configurations

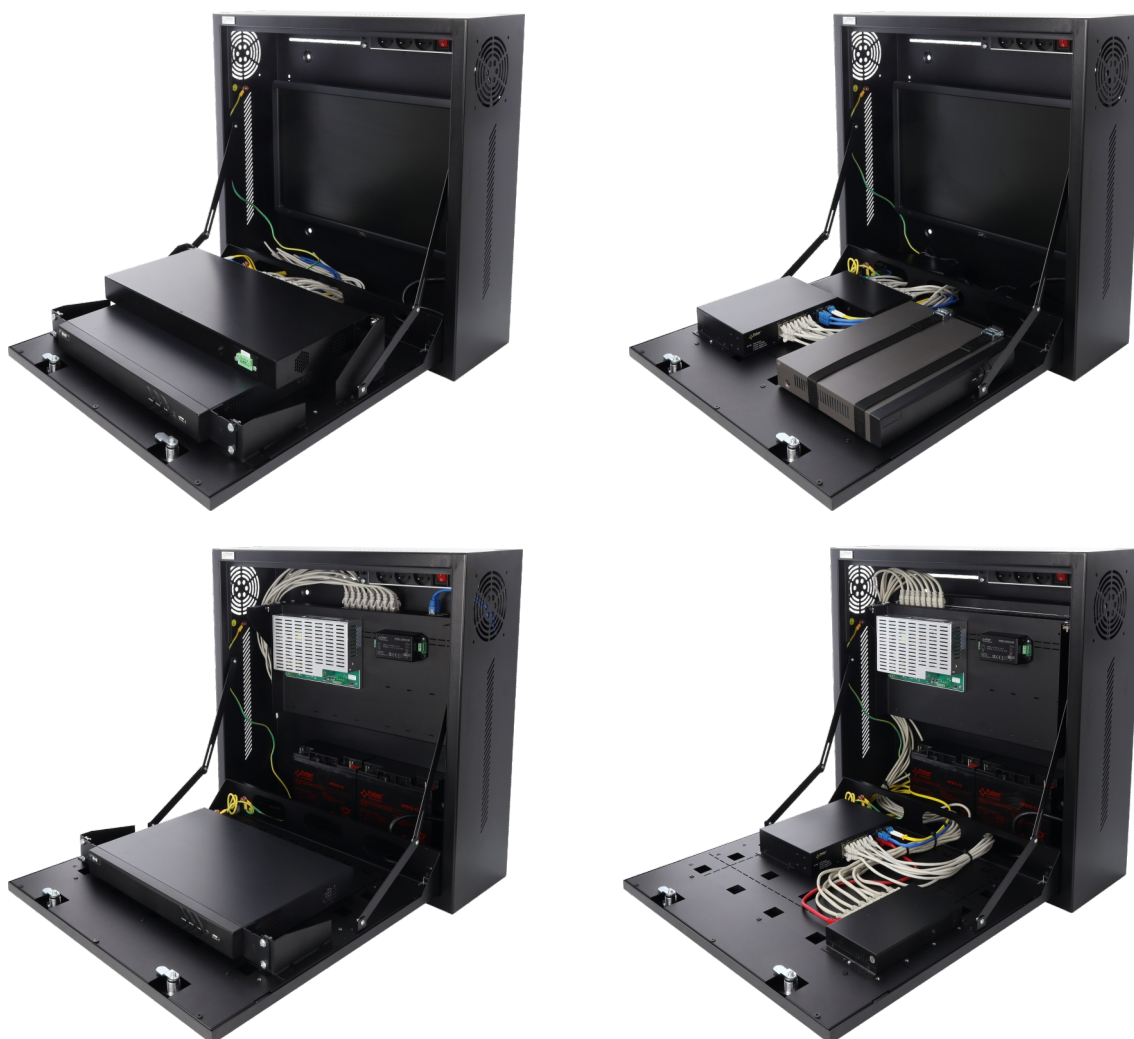

Sample assembly – monitor / recorder / PoE switches / PSU with battery backup for switches and recorder