



Network

Dome

## QNV-7022R

4MP IR Vandal Dome Camera



### Key Features

- Maximum 4MP resolution
- Color : 0.15Lux (F1.6, 1/30sec) B/W : 0Lux (IR LED On)
- 4mm fixed focal
- Maximum 30fps@4MP all resolutions (H.265/H.264)
- H.265, H.264, MJPEG codec supported, Multiple streaming
- Motion detection, Tampering, Defocus detection
- Hallway view (90°/270°), LDC support
- Micro SD/SDHC/SDXC memory slot (128GB)
- IR viewable length 25m (82.02ft)
- IP66, IK10, PoE, 12VDC

# QNV-7022R

4MP IR Vandal Dome Camera



## Specifications

### Video

|                   |   |
|-------------------|---|
| Imaging Device    | 1/3" CMOS   |
| Resolution        | 2560 x 1440, 1920 x 1080, 1280 x 960, 1280 x 720, 800 x 600, 800 x 448, 720 x 576, 720 x 480, 640 x 480, 640 x 360, 320 x 240 |
| Max. Framerate    | H.265/H.264 : Max. 30fps at 4M all resolutions, MJPEG : Max. 15fps  |
| Min. Illumination | Color : 0.15Lux (F1.6, 1/30sec)<br>B/W : 0Lux (IR LED On)   |
| Video Out         | CVBS : 1.0 Vpp/75Ω composite, 720x480(N), 720x576(P) for installation   |

### Lens

|                           |                              |
|---------------------------|------------------------------|
| Focal Length (Zoom Ratio) | 4mm fixed focal              |
| Max. Aperture Ratio       | F1.6                         |
| Angular Field of View     | H : 78.2, V : 41.2, D : 92.0 |
| Focus Control             | Fixed                        |

### Pan / Tilt / Rotate

|                           |                                  |
|---------------------------|----------------------------------|
| Pan / Tilt / Rotate Range | 0° ~ 350° / 0° ~ 67° / 0° ~ 355° |
|---------------------------|----------------------------------|

### Operational

|                          |  |
|--------------------------|--|
| Camera Title             | Displayed up to 85 characters  |
| Day & Night              | Auto(ICR)  |
| Backlight Compensation   | BLC, WDR, SSSR   |
| Wide Dynamic Range       | 120dB  |
| Digital Noise Reduction  | SSNR   |
| Motion Detection         | 4ea, polygonal zones   |
| Privacy Masking          | 6ea, rectangular zones   |
| Gain Control             | Low / Middle / High  |
| White Balance            | ATW / AWC / Manual / Indoor / Outdoor  |
| LDC                      | Support  |
| Electronic Shutter Speed | Minimum/Maximum/Anti flicker (1/5~1/12,000sec)   |
| Video Rotation           | Flip, Mirror, Hallway view(90/270)   |
| Analytics                | Defocus detection, Directional detection, Motion detection, Enter/Exit, Tampering, Virtual line                                  |
| Alarm I/O                | Input 1ea / Output 1ea   |
| Alarm Triggers           | Analytics, Network disconnect, Alarm input   |
| Alarm Events             | File upload via FTP and e-mail, Notification via e-mail, SD/SDHC/SDXC or NAS recording at event triggers, Alarm output, Handover |
| Audio In                 | Selectable(mic in/line in)<br>Supply voltage: 2.5VDC(4mA), Input impedance: 2K Ohm   |
| IR Viewable Length       | 25m (82.02ft)  |

### Network

|                   |                                |
|-------------------|--------------------------------|
| Ethernet          | RJ-45 (10/100BASE-T)           |
| Video Compression | H.265/H.264 : Main/High, MJPEG |

|  |   |
|--|---|
| <b>Audio Compression</b>                 | G.711 u-law / G.726 Selectable<br>G.726(ADPCM) 8KHz, G.711 8KHz,<br>G.726 16Kbps, 24Kbps, 32Kbps, 40Kbps  |
| <b>Smart Codec</b>                       | Manual (Sea area), WiseStream II  |
| <b>Bitrate Control</b>                   | H.264/H.265 : CBR or VBR<br>MJPEG : VBR   |
| <b>Streaming</b>                         | Unicast (6 users) / Multicast<br>Multiple streaming (Up to 3 profiles)  |
| <b>Protocol</b>                          | IPv4, IPv6, TCP/IP, UDP/IP, RTP(UDP), RTP(TCP), RTCP, RTSP, NTP, HTTP, HTTPS, SSL/TLS, DHCP, PPPoE, FTP, SMTP, ICMP, IGMP, SNMPv1/v2c/v3(MIB-2), ARP, DNS, DDNS, QoS, PIM-SM, UPnP, Bonjour, LLDP |
| <b>Security</b>                          | HTTPS(SSL) Login Authentication<br>Digest Login Authentication<br>IP Address Filtering<br>User access Log<br>802.1X Authentication  |
| <b>Application Programming Interface</b> | ONVIF Profile S/G/T, SUNAPI (HTTP API)  |

## General

|                         |  |
|-------------------------|--|
| <b>Webpage Language</b> | English, Korean, Chinese, French, Italian, Spanish, German, Japanese, Russian, Portuguese, Czech, Polish, Turkish, Dutch, Hungarian, Greek |
| <b>Edge Storage</b>     | Micro SD/SDHC/SDXC 1slot 128GB   |
| <b>Memory</b>           | 512MB RAM, 256MB Flash   |

## Environmental & Electrical

|   |   |
|---|---|
| <b>Operating Temperature / Humidity</b> | -40C~+55C (-40F~+131F) / Less than 95% RH<br>* Start up should be done at -30C or above |
| <b>Storage Temperature / Humidity</b>   | -40C~+60C (-40F~+140F) / Less than 95% RH   |
| <b>Certification</b>                    | IP66, IK10  |
| <b>Input Voltage</b>                    | PoE(IEEE802.3af, Class3), 12VDC   |
| <b>Power Consumption</b>                | PoE: Max 10.7W, typical 8.1W<br>12VDC: Max 9.1W, typical 6.5W                           |

## Mechanical

|  |  |
|--|--|
| <b>Color / Material</b>                  | White / Aluminum                                 |
| <b>RAL Code</b>                          | RAL9003  |
| <b>Product Dimensions / Weight</b>       | Ø120.3 x 91.7mm (Ø4.74 x 3.61"), 510g (1.124 lb) |
| <b>Compatible Conduit hole / Gangbox</b> | - SBD-120GP : Single, Double, 4"Octagon          |
| <b>Hanging Mount (Dome)</b>              | SBP-122HMW                                       |
| <b>Backbox</b>                           | SBV-120GW  |

## DORI (EN62676-4 standard)

|                                  |                 |
|----------------------------------|-----------------|
| <b>Detect (25PPM/ 8PPF)</b>      | 63.0m(206.70ft) |
| <b>Observe (63PPM/ 19PPF)</b>    | 25.2m(82.68ft)  |
| <b>Recognize (125PPM/ 38PPF)</b> | 12.6m(41.34ft)  |
| <b>Identify (250PPM/ 76PPF)</b>  | 6.3m(20.67ft)   |

# QNV-7022R

4MP IR Vandal Dome Camera



CAD

Unit: mm [inch]

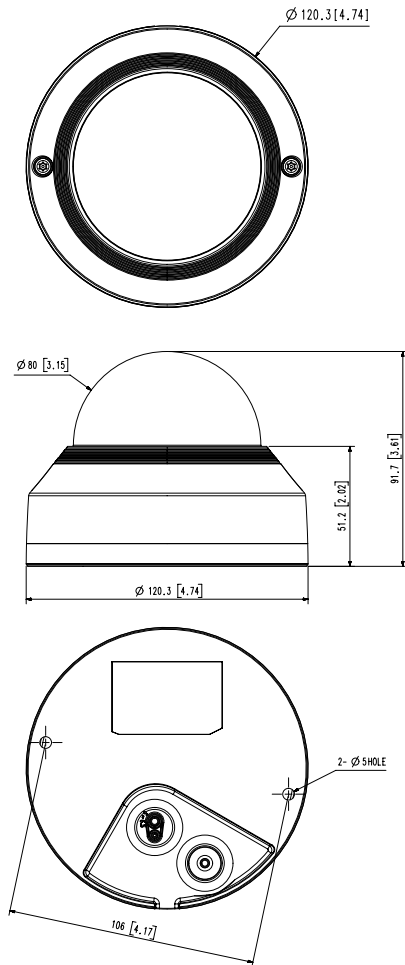

QNV-6012R/6022R/6032R  
QNV-8010R/8020R/8030R  
UNIT : mm[inch]